

Honeywell

ScanPal EDA60K-HB

快速入门指南 Quick Start Guide



用错误型号电池更换会有爆炸危险，务必按照说明处置用完的电池，请按当地规定处理电池。请在可能的情况下回收电池。不可将电池作为生活垃圾处理。

If you replace the battery with the wrong type, there will be an explosion hazard risk. Be sure to dispose of the exhausted batteries according to the instructions. Please follow the local rules to handle the battery. Please recycle batteries as often as possible. Batteries must not be treated as domestic waste.

3 中国RoHS China RoHS table

15 产品中有害物质的名称及含量 Names and content of Hazardous Substances in the Product						
部件名称 (Parts Name)	有害物质 Hazardous substance					
	铅 (Pb)	汞 (Hg)	镉 (Cd)	六价铬 (Cr6+)	多溴联苯 (PBB)	多溴二苯醚 (PBDE)
印刷线路板	X	O	O	O	O	O
本表格依据SJ/T 11364的规定编制。 (This table is created in accordance to SJ/T 11364)						
o: 表示该有害物质在该部件所有均质材料中的含量均在GB/T 26572标准规定的限量要求以下。(Indicates that this hazardous substance contained in all of the homogeneous materials for this part is below the limit requirement in China's GB/T26572)						
x: 表示该有害物质至少在该部件的某一均质材料中的含量超出GB/T 26572 标准规定的限量要求。(Indicates that this hazardous substance contained in at least one of the homogeneous materials for this part is above the limit requirement in China's GB/T26572)						

4 CE Europe

The CE marking indicates compliance with following directives:

- 2014/30/EU - EMC Directive
- 2011/65/EU - RoHS (recast)

In addition, compliance to 2014/35/EU-Low Voltage Directive when used with the recommended power source

Manufacture Contact Information:

Honeywell International Inc.

Honeywell Sensing & Productivity Solutions

9680 Old Bailes Road Fort Mill, SC 29707 USA

Europe contact: Hand Held Products Europe B.V.

Lagelandseweg 70,6545CG NijmegenThe Netherlands

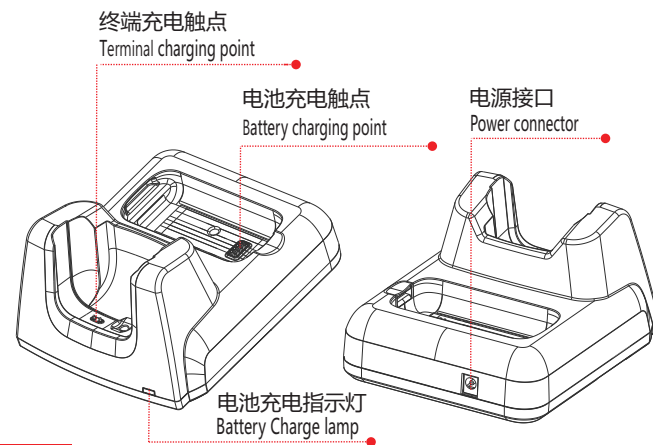

1

2 连接说明 Connect Description

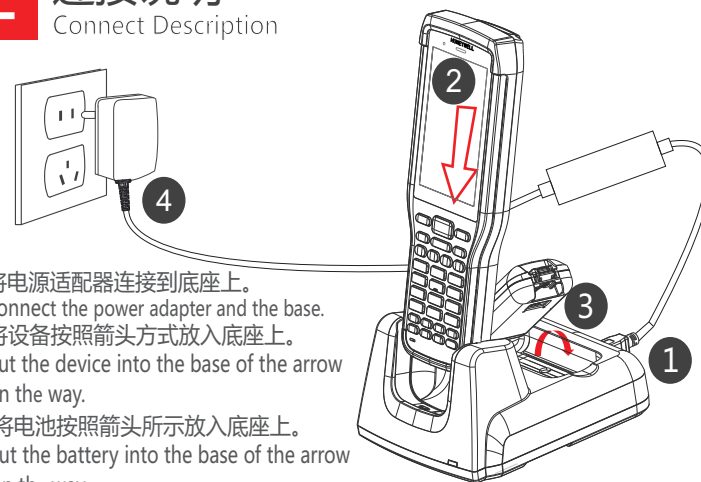

1. 将电源适配器连接到底座上。
Connect the power adapter and the base.
2. 将设备按照箭头方式放入底座上。
Put the device into the base of the arrow on the way.
3. 将电池按照箭头所示放入底座上。
Put the battery into the base of the arrow on the way.
4. 连接电源,EDA60K指示灯亮即表示终端充电。
底座指示灯显示橙色表示电池单体在充电，绿色表示已充满。
Connect the adapter,EDA60K LED on means on charging.
The HB orange lamp on means spared battery on charging and green lamp on means full charging.

! 请使用EDA60K自带的电源适配器。
Please use the EDA60K that comes with power adapter.

5 技术支持 Technical Support

技术支持 产品售后服务,维修相关联系信息, 请访问
www.honeywellaidc.com.
Technical support, after-sales service, maintenance-related contact information, please visit the www.honeywellaidc.com.

用户文档(User documentation)

对于本文件的本地话版本, 请访问 www.honeywellaidc.com
For the local version of this document, please visit the www.honeywellaidc.com

专利 (Patent)

关于专利信息, 请参照 (On patent information, please refer to)
www.honeywellaidc.com/patents.

保修期限(Warranty period)

请登录www.honeywellaidc.com/warranty-information获取您产品的保修信息。 Please visit the Web site, get your product warranty information.

免责声明(Disclaimer)

Honeywell International Inc (霍尼韦尔国际公司) 保留在没有事先通知的情况下改变规格和其他信息的权利。读者应该随时咨询霍尼韦尔国际公司, 已确定是否已经做出这种变化。本文中的信息并不是霍尼韦尔国际公司承诺的一部分。霍尼韦尔国际公司不承担技术, 编辑错误或遗漏所造成的直接和间接损失; Honeywell International Inc (Honeywell International companies) remain in the without prior notification in case the right to change specifications and other information. The reader should feel free to contact Honeywell International, determine whether this has made. The information in this article is not part of Honeywell International commitments.Honeywell International company is not responsible for technical, editorial errors or omissions caused by the directAnd indirect losses;
本文档包含受版权保护的专有信息。保留所有权利。在没有霍尼韦尔国际公司事先书面同意的情况下, 本文档的任何部分不得复印, 复制, 或翻译成另一种语言。

This document contains proprietary information protected by copyright. All rights reserved. In the absence of case of Honeywell International's prior written consent, and any part of the document.Not be copied, reproduced, or translated into another language.

2017 Honeywell International Inc 版权所有 网址: www.honeywellaidc.com

正面

Honeywell

ScanPal EDA60K-HB

快速入門指南 Quick Start Guide



EDA60K-HB-QS Rev B

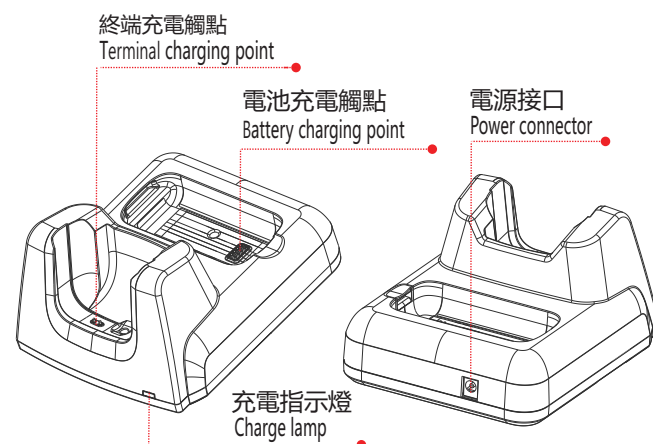

1

2 連接說明 Connect Description

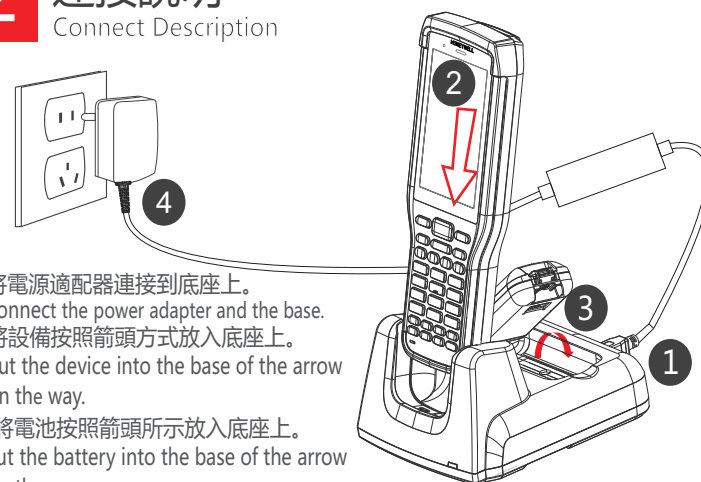

1. 將電源適配器連接到底座上。
Connect the power adapter and the base.
2. 將設備按照箭頭方式放入底座上。
Put the device into the base of the arrow on the way.
3. 將電池按照箭頭所示放入底座上。
Put the battery into the base of the arrow on the way.
4. 連接電源,EDA60K指示燈亮即表示終端充電。
底座指示燈顯示橙色表示電池單體在充電，綠色表示已充滿。
Connect the adapter,EDA60K LED on means on charging.
The HB orange lamp on means spared battery on charging and green lamp on means full charging.

! 請使用EDA60K自帶的電源適配器。
Please use the EDA60K that comes with power adapter.

3 技術支持 Technical Support

技術支持,產品售後服務,維修相關聯繫信息,請訪問
www.honeywellaidc.com.
Technical support, after-sales service, maintenance-related
contact information, please visit the www.honeywellaidc.com.

用戶文檔(User documentation)
對於本文件的本地話版本,請訪問 www.honeywellaidc.com
For the local version of this document, please visit the
www.honeywellaidc.com

專利 (Patent)
關於專利信息,請參照 (On patent information, please refer to)
www.honeywellaidc.com/patents.

保修期限(Warranty period)
請登錄www.honeywellaidc.com/warranty-information.獲取你產品的保修信息
Please visit the Web site, get your product warranty information.

免責聲明(Disclaimer)
Honeywell International Inc (霍尼韋爾國際公司) 保留在沒有事先通知的情況下改變規格和其他信息的權利。讀者應該隨時諮詢霍尼韋爾國際公司,已確定是否已經做出這種變化。本文中的信息並不是霍尼韋爾國際公司承諾的一部分。霍尼韋爾國際公司不承擔技術,編輯錯誤或遺漏所造成的直接和間接損失。
Honeywell International Inc (Honeywell International companies) remain in the without prior notification in case the right to change specifications and other information. The reader should feel free to contact Honeywell International, determine whether this has made. The information in this article is not part of Honeywell International commitments.Honeywell International company is not responsible for technical, editorial errors or omissions caused by the direct and indirect losses;
本文檔包含受版權保護的專有信息。保留所有權利。在沒有霍尼韋爾國際公司事先書面同意的情况下,本文檔的任何部分不得複印,複製,或翻譯成另一種語言。
This document contains proprietary information protected by copyright. All rights reserved. In the absence of case of Honeywell International's prior written consent, and any part of the document.Not be copied, reproduced, or translated into another language.

2017 Honeywell International Inc 版權所有 網址: www.honeywellaidc.com

4 CE

Europe
The CE marking indicates compliance with following directives:
• 2014/30/EU - EMC Directive
• 2011/65/EU - RoHS (recast)

In addition, compliance to 2014/35/EU-Low Voltage Directive when used with the recommended power source

Manufacture Contact Information:
Honeywell International Inc.
Honeywell Sensing & Productivity Solutions
9680 Old Bailes Road Fort Mill, SC 29707 USA

Europe contact:
Hand Held Products Europe B.V.
Lagelandseweg 70,6545CG NijmegenThe Netherlands

Honeywell

反面